

THE INTERNATIONAL CENTRE

Hall 1

HALL 1 DIMENSION

Total Square Feet	103,000	Loading Docks	13
Ceiling Clearance	15' - 33'	Dock Dimensions (w x h)	10'11" x 8'
Column Span	35' x 35'	Drive-In Doors	1
Column Size (w x h)	2' x 2'	Drive-In Doors Dimensions (w x h)	12' x 13'

CAPACITIES

	Sq. Ft.	Theatre	Banquet ¹	Classroom	Booths ²
Hall 1	103,000	6,275	5,093	4,745	390
Meeting Room 101	874	63	60	36	-
Meeting Room 102	912	63	60	36	-
Meeting Room 103	677	30	30	14	-
Meeting Room 104	1,090	96	80	36	-

¹10 people per round table, ²Based on booth dimension of 10'x10'. Certain set-ups, layout, and A/V will reduce capacities. Floorplan specifications subject to change without notice. All rights reserved. E. & O.E. July 2023.

LEGEND

	RESERVED DOORS		F4/FHC FIRE HOSE/FIRE HOSE CABINET
	LOADING DOORS		FIRE EXIT
	MAN DOORS		TEMPORARY EMERGENCY EXIT
	DRIVE-IN DOORS		MENS WASHROOM
	ROLL-UP DOORS		WOMENS WASHROOM
	MARKED ROLL-UP DOORS		BARRIER FREE WASHROOM
	BANK MACHINE		FAMILY WASHROOM
	FLOOR DRAIN		BABY CHANGE COUNTER
	MUST LEAVE ACCESS		PERMANENT FOOD AREA

CEILING HEIGHTS PER HALL
(for critical areas see floor plan)

CONF CENTRE	= 16'
HALL 1	= 33'
HALL 1 DOCKS	= 15'
HALL 2	= 23'
HALL 2 DOCKS	= 18'
HALLS 3-4	= 20'
HALL 5	= 23'
HALL 6	= 20'

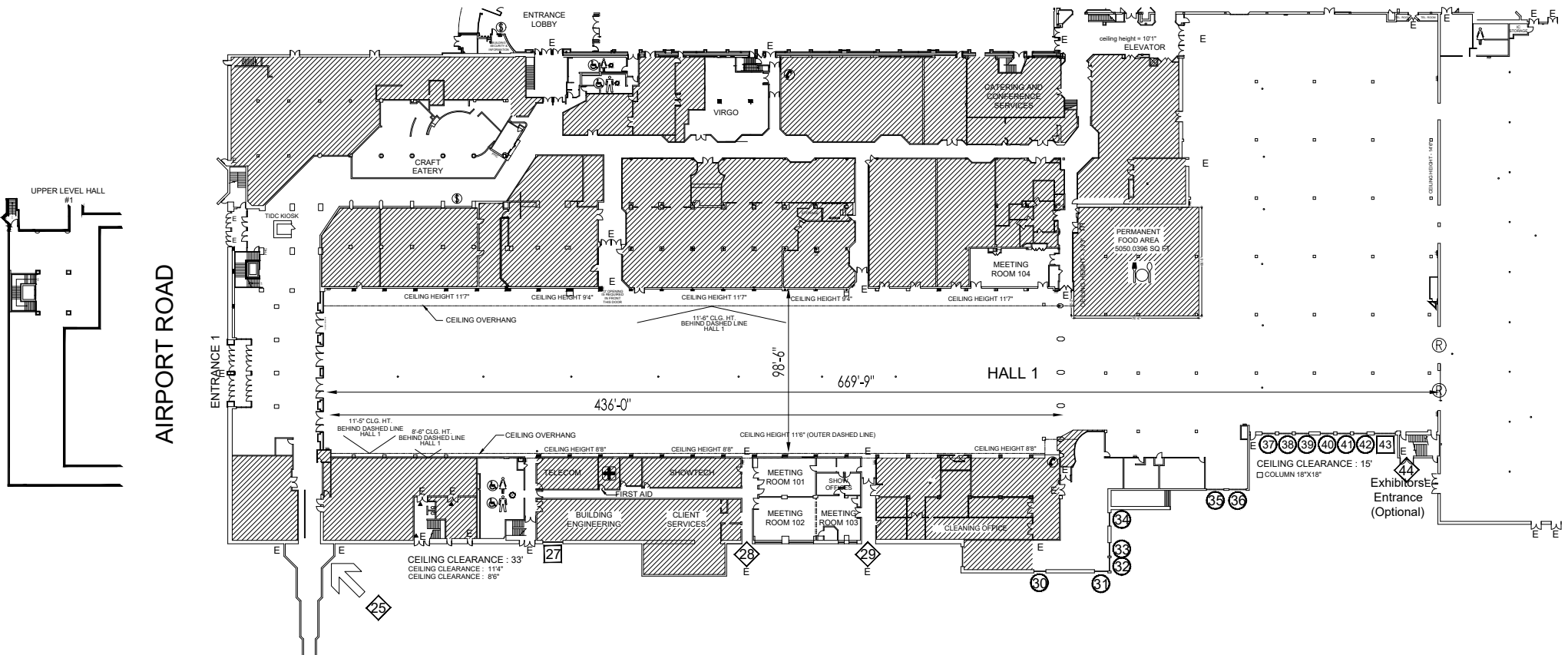

THE INTERNATIONAL CENTRE

Hall 1 & Conference Centre

HALL 1 DIMENSION

Total Square Feet	103,000	Loading Docks	13
Ceiling Clearance	15' – 33'	Dock Dimensions (w x h)	10'11" x 8'
Column Span	35' x 35'	Drive-In Doors	1
Column Size (w x h)	2' x 2'	Drive-In Doors Dimensions (w x h)	12' x 13'

CAPACITIES	Sq. Ft.	Theatre	Banquet ¹	Classroom	Booths ²
Hall 1	103,000	6,275	5,093	4,745	390
Meeting Room 101	874	63	60	36	–
Meeting Room 102	912	63	60	36	–
Meeting Room 103	677	30	30	14	–
Meeting Room 104	1,090	96	80	36	–

¹10 people per round table, ²Based on booth dimension of 10'x10'. Certain set-ups and A/V will reduce capacities. Floorplan specifications subject to change without notice. All rights reserved. E. & O.E. April 2019.

CONFERENCE CENTRE DIMENSION

Total Square Feet	42,873	Dock Dimensions (w x h)	7'9" x 8'10"
Ceiling Clearance	16' – 18'	Drive-In Doors	1
Loading Docks	2	Drive-In Doors Dimensions (w x h)	11'8" x 16'

CAPACITIES	Sq. Ft.	Theatre	Banquet ¹	Classroom	Reception
Orion Ballroom	17,068	1,970	1,400	970	1,970
Vela	4,267	500	350	220	450
Phoenix	4,267	500	350	220	450
Lyra	2,028	190	150	80	210
Pegasus	2,900	310	200	130	310
Virgo	1,568	150	90	60	150
Aquarius	530	40	30	20	50
Pisces	244	–	–	–	–
Tucana	225	–	–	–	–
Grand Lobby	11,344	–	–	–	1,200

Legend

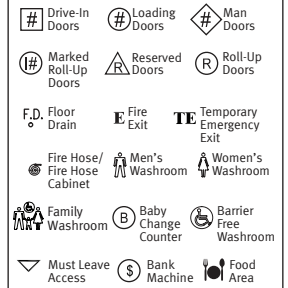

AIRPORT ROAD

